



APPLICATIONS:

- » Industrial Processes
- » Cooling Towers
- » Chemical Processes
- » and more...



PFI Series Industrial Pump Packages

Ref. PF-Ind 2021



- Fusion bonded polyester coated, non-code carbon steel construction.
- Manual air bleed valve, liquid filled inlet/outlet pressure gauges.
- Centrifugal pump with NEMA PE TEFC motor, and cast iron pre-strainer.
- Fusion bonded polyester coated carbon steel skid and interconnecting piping.
- UL labeled control panel with lockable main door disconnect, motor starter with short-circuit/overload protection, purge timer with HOA switch, remote pump start-stop Local/Off/Remote switch, and remote dry contact signals.
- Industrial grade purge valve with electric actuator.

MODEL	FLOW GPM	MOTOR	INLET	OUTLET	DIMENSIONS			WEIGHT, LBS	
Number	GPM	HP	Size	Size	L	H	W	Shipping	Oper.
PFI-050-AP	50	1.5	2"	1.25"	30"	43"	28"	313	286
PFI-075-AP	75	2	2"	1.5"	30"	43"	28"	330	296
PFI-100-AP	100	3	2"	2"	32"	50"	34"	436	437
PFI-200-AP	200	5	3"	3"	37"	51"	34"	577	580
PFI-300-AP	300	7.5	4"	4"	40"	63"	36"	1197	1124
PFI-400-AP	400	10	4"	4"	44"	63"	36"	1332	1259
PFI-550-AP	550	15	6"	5"	49"	75"	42"	1490	1513
PFI-0850-AP	850	20	6"	6"	49"	89"	46"	1655	1729
PFI-1100-AP	1100	25	6"	6"	48"	88"	50"	2150	2253

Consult factory for larger sizes not shown.

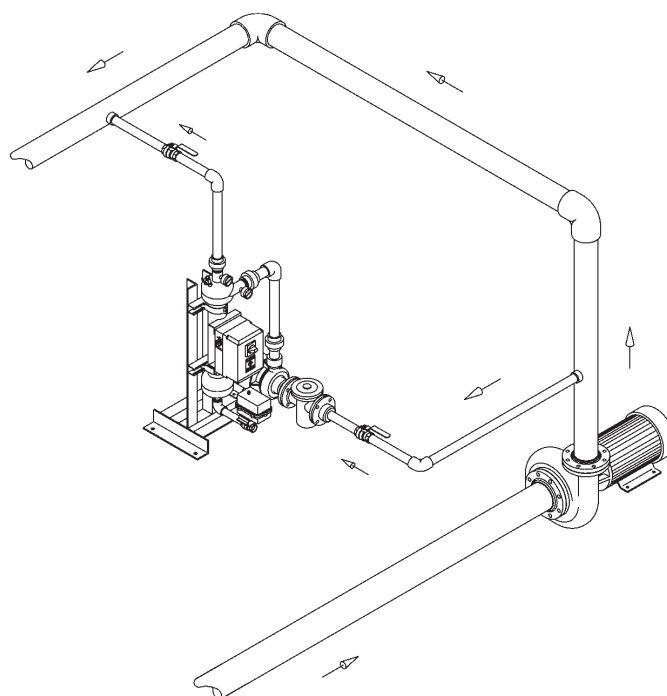
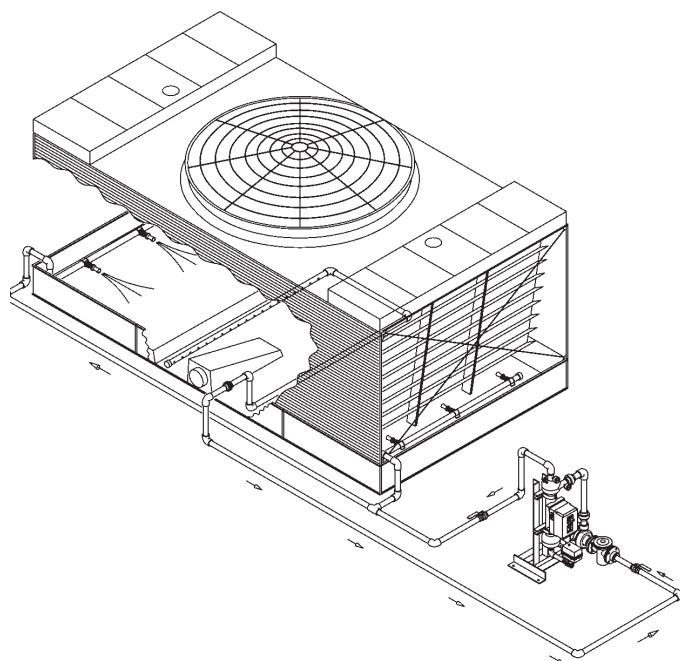

PFIS Series Industrial Hydrocyclone Separators



RECOMMENDED DIRECTION OF INLET/OUTLET PIPING TO CONTROL HARMONIC OSCILLATION

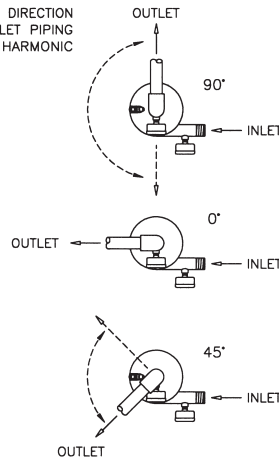

- Available in flow rates up to 18,000 GPM.
- Particle removal of 25-microns and larger.
- Fusion bonded polyester powder coated carbon steel vessel, 150 PSI rated.
- Industrial grade manual purge valve, 1/4" manual air bleed valve, and 0-160 PSI liquid filled gauges.
- Options available: ASME code stamp, stainless steel construction, higher pressure rating, removable dome, manual purge.

MODEL	FLOW RANGE	INLET	OUTLET	DIMENSIONS			WEIGHT, LBS	
				Number	GPM	Size	Size	L
PFIS-050-AP	50 - 100	1-1/2"	1-1/2"	9"	39"	8"	27	40
PFIS-100-AP	65-135	2"	2"	12"	48"	12"	74	125
PFIS-150-AP	100-200	2.5"	2.5"	12"	48"	12"	77	130
PFIS-200-AP	160-315	3"	3"	14"	45"	13"	98	156
PFIS-300-AP	220-440	4"	4"	24"	59"	15"	175	275
PFIS-550-AP	375-750	5"	5"	25"	70"	16"	256	414
PFIS-900-AP	620-1245	6"	6"	28"	82"	18"	385	650
PFIS-1600-AP	1170-2335	8"	8"	30"	96"	20"	570	1002
PFIS-3000-AP	1965-3930	10"	10"	38"	117"	25"	996	1809

Consult factory for larger sizes not shown.

Flow Rate vs. Pressure Loss

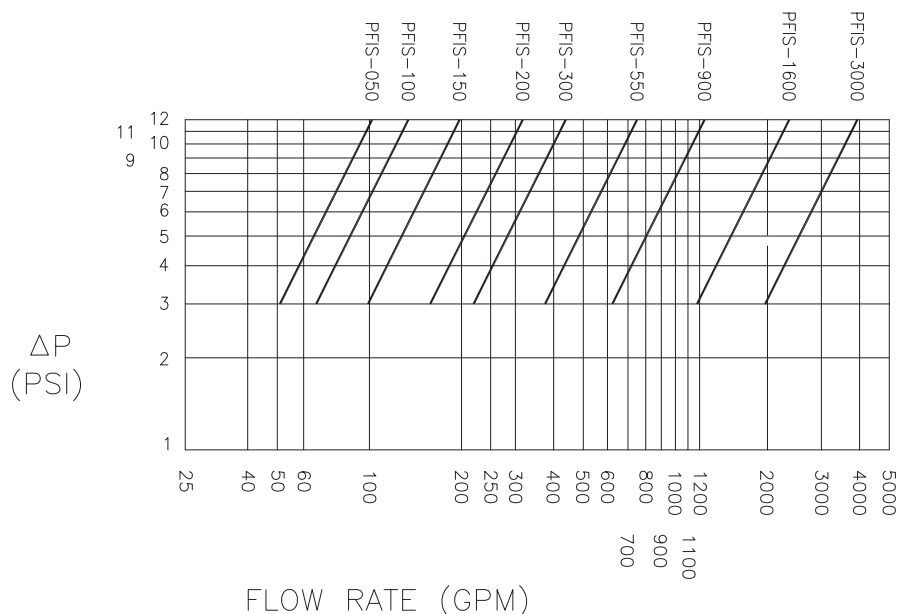



BENEFITS

- Designed to remove dirt and debris effectively from industrial cooling water.
- Maintain system design efficiency by reduction of fouling.
- Reduce manual basin cleaning time.
- Reduce water loss.
- Extend overall equipment life expectancy.
- Optimize water treatment.
- Reduce unscheduled downtime.

TYPICAL APPLICATIONS INCLUDE:

- | | | |
|-------------------|-------------------------|------------------------|
| • Cooling Towers | • Well Water | • Industrial Processes |
| • Food Industries | • Waste Water Discharge | • Automotive Processes |
| • Intake | • Potable Water | • Chemical Processes |
| • Pre-Filter | • Nozzle Protection | • Car Washes |



A division of Puroflux Corporation

(805) 579-0216 Fax: 579-6005
website: www.puroflux.com • e-mail: sales@puroflux.com